

SERBLOC

antirotation

blind rivet nut

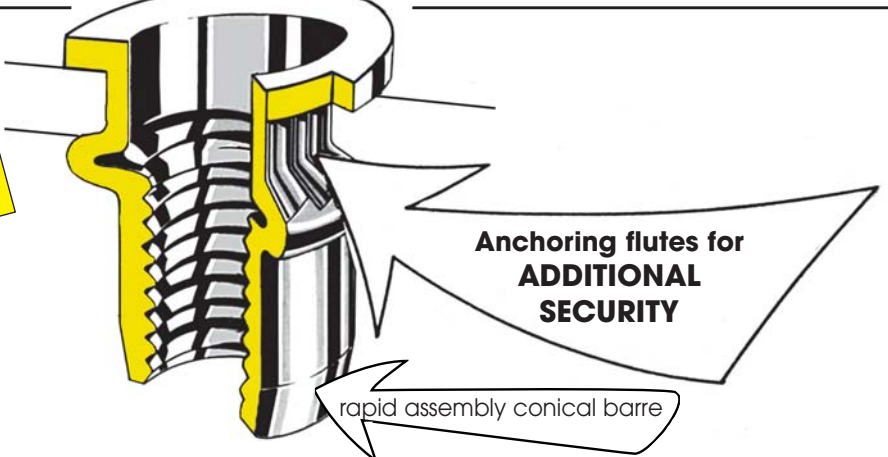

ADVANTAGES

When setting, the flutes anchor the SERBLOC nut in the support, giving it considerable clamping strength. Torque resistance is higher than that of a class 6.8 steel screw.

APPLICATIONS

The SERBLOC nut is fluted to allow blind fastening in metal sheets, plastic, wood and other conglomerate materials like laminated Isorel or similar products.

AND EVERYWHERE WHEN :

- the support is too thin for resistant threading
 - blind mounting is necessary because the other side of the support is unaccessible (tubes - hollow sections)
 - a removable mounting is required
 - crimping of one or several parts that are to be screw-mounted to other parts
 - inserting threading in painted, polished, enamelled parts is delicate
- Furthermore, recessed threading makes the SERBLOC nut leakproof to fluid and humidity.

MOUNTING

Support preparation.

The cylindrical housing P can be made by punching or drilling. For countersunk heads, provide a countersink F that allows the SERBLOC to protrude the support surface by 0.1 mm. It is essential to respect dimension P in our tables.

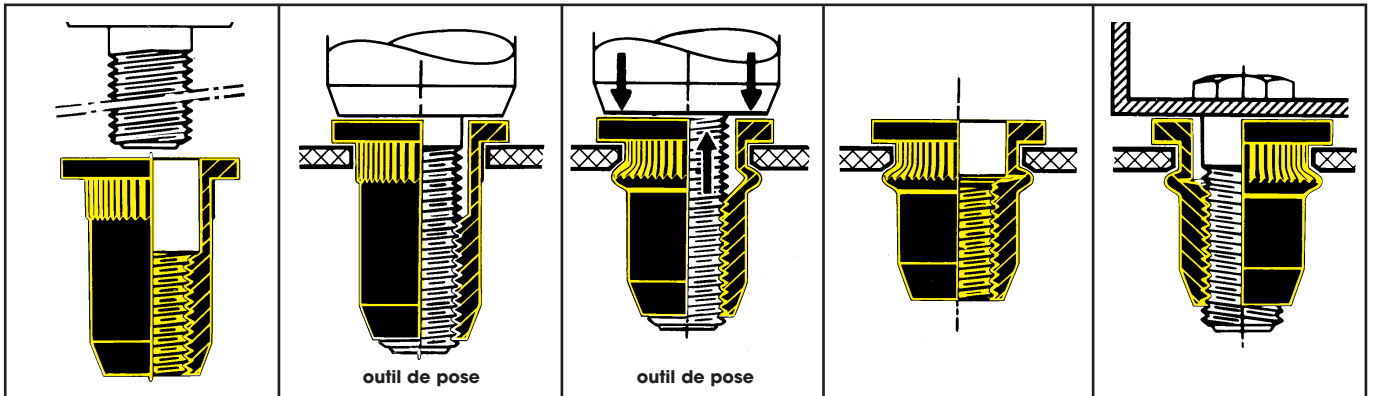

1 - Screw the SERBLOC nut into the screw rod of the tool abutting on the machine nosepiece.

2 - Insert the SERBLOC nut in the hole drilled in the support.

3 - Actuate the handles or the trigger of the mounting tool. Traction is produced on the threaded section of the SERBLOC nut, causing the cylindrical drum on the mock or blind side to expand fixing the SERBLOC in its support.

4 - Now that the SERBLOC nut is fixed, complete security is provided. The flutes have penetrated the support to be crimped, anchoring the SERBLOC nut. Unscrew the screw rod of the mounting tool.

5 - The SERBLOC nut is ready for screw or attachment mounting providing a solid threading in thin or hollow elements.

MATERIAL AND FINISH

The SERBLOC nuts can be in : zinc plated, yellow chromating STEEL or with other forms of protection on demand - BRASS - ALUMINIUM alloys - STAINLESS STEEL.

SERBLOC CHOICE

It is important to choose exactly, depending on use :

- the diameter of the screw to be used
- the material and finish of the SERBLOC
- the type of head : standard flat head « TP », large « TPL », countersunk head « TF », SERFIN « S »
- its characteristics, open or closed B, for reasons of leakproofing and corrosion
- the thickness to be crimped of the support S determines the SERBLOC reference mentioned on each of our tables and corresponds to the crimping range contained between minimum and maximum thickness that the SERBLOC can conveniently crimp.

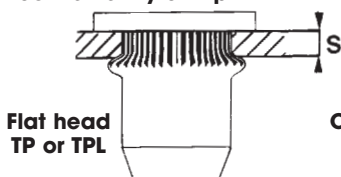

Countersunk head TF

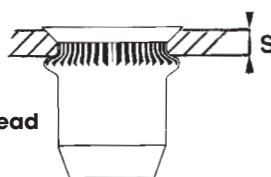

Serfin S

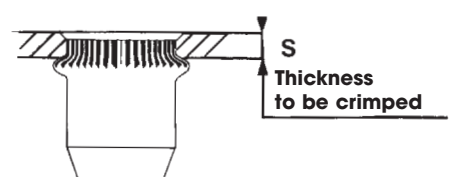

S Thickness to be crimped

SERBLOC

antirotation

blind rivet nut

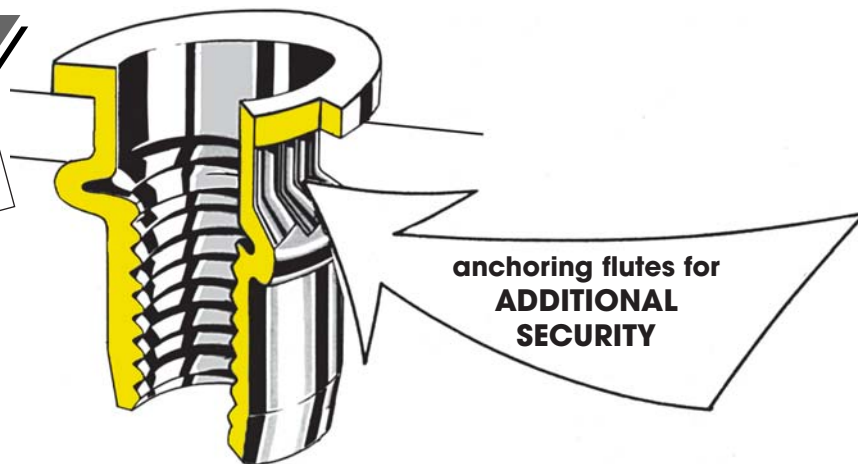

TECHNICAL CHARACTERISTICS

TIGHTENING TORQUE (Nm)			EXTRACTION LOAD (N)		SHEARING (N)	
M	Steel SERBLOC	Aluminium SERBLOC	Steel SERBLOC	Aluminium SERBLOC	Steel SERBLOC	Aluminium SERBLOC
3	2,0	0,6	3 950	2 600	1 900	900
4	5,0	2,0	5 390	4 215	2 845	1 765
5	12,0	4,0	7 740	5 390	4 361	2 595
6	30,0	8,0	10 584	5 880	6 270	2 945
8	51,0	15,0	15 680	7 750	7 250	4 165
10	70,0	16,0	19 110	10 260	7 450	4 560
12	100,0	38,0	32 500	14 360	9 600	7 350

Values given in this table are for information purposes only.

TIGHTENING TORQUE

It should be noted that all tests were performed using steel treated bolts with a breaking load (R) of 2100 N/mm² and an elastic limit (E) of 1800 N/mm².

In comparison, standard bolts of soft steel have much lower resistances, $r = 450 \text{ N/mm}^2$, $E = 250 \text{ N/mm}^2$. For example, in the recommended tightening torques (C) and tensile load (T), for soft and treated steel bolts. $R = 1300 \text{ N/mm}^2$, $5 = 900 \text{ N/mm}^2$.

Ø	SOFT STEEL		TREATED STEEL		Ø	SOFT STEEL		TREATED STEEL	
	C (Nm)	T (Nm)	C (Nm)	T (Nm)		C (Nm)	T (Nm)	C (Nm)	T (Nm)
4	1,2	1 650	4,2	5 900	8	9,3	6 860	33,6	24 700
5	2,5	2 660	8,1	9 600	10	18,7	10 870	67,2	39 150
6	3,9	3 770	14,0	13 600	12	31,8	15 800	114,0	56 900

Tightening torques and tensile loads on the bolt have been defined at 3/4 of the bolt elastic limit for a friction coefficient of 0.12, corresponding to carefully manufactured, mounted and lubricated bolts. For the same sort of bolt and with a given diameter, tensile loads are proportional to lightening torque.

Consequently, if one applies a 20 Nm torque to a soft steel bolt with a diameter of 10, the tensile load will be :

$$10.870 \times 20 = 11.625 \text{ N. Inversely, the torque causing a load of } 9,800 \text{ N will be : } 18.7 \times 9.800 = 16.8 \text{ Nm}$$

18.7

10.870

EXTRACTION LOADS (Fe)

These vary depending on the thickness of support to be crimped (S) and can be calculated by using the following formula : $Fe = 0.5 \times S^{1.5} \times D \times La$ (D = SERBLOC barrel diameter, La = apparent elastic limit).

SERBLOC SHEARING RESISTANCE

Figures in the table have been obtained using dimensionally stable sections without the bolt being fixed.

a few applications

Mounting a support on reinforced polyster or other thin plastic sections, as well as laminated or polywood surfaces.

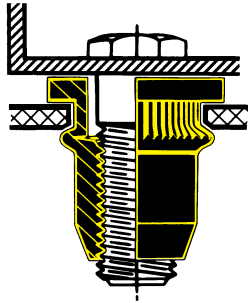

SERBLOC TP

Boat hulls, top hampers, car bodies, industrial vehicles, kitchen and office fittings, computers, etc.

Linking in a hollow section.

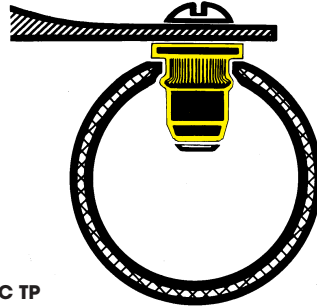

SERBLOC TP

Metal office, garden and camping furniture, roller shutter mechanisms, etc.

Liquid and humidity tight assemblies.

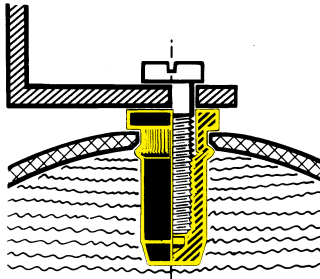

SERBLOC TPB

Leaktight mounting of a support on fuel or oil tanks, upper works, etc.

Mounting of several supports with the option of fixing other connected elements.

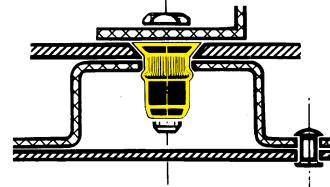

SERBLOC TF

Protective and decorative internal aven plates, lifts, service elevators, tractor cabins, ski lifts, construction equipment, refrigeration equipment, etc.

Blind mounting of SERBLOC TF in a hollow section.

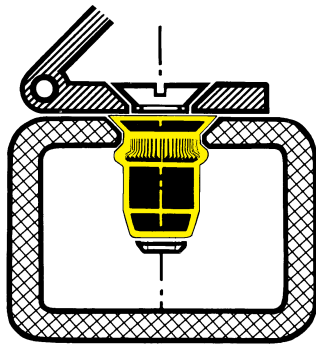

SERBLOC TF

Refrigerating equipment, household appliances, car bodies, agricultural machinery, metal structures, etc.

Mounting a hollow section on a wooden support platform.

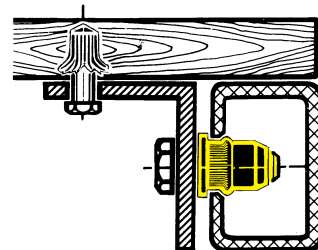

SERBLOC TP

Office furniture, rolling stock, naval construction, top hampers, etc.

SUMMARY

	Page
Technical Data	1
Examples of different uses	2
<u>SERBLOC :</u>	
Flat Head (Open ended knurled in stainless steel or steel) TP Type	4
Flat Head (Blind ended knurled in stainless steel or steel) TPB Type	5
Large Flat Head (Flange open ended knurled in stainless steel or steel) TPL Type ..	6
Large Flat Head (Blind ended knurled in stainless steel or steel) TPLB Type	7
Countersunk Head (Open ended knurled in stainless steel or steel) TF Type	8
Countersunk Head (Blind ended knurled in stainless steel or steel) TFB Type	9
<u>SERFIN :</u>	
Flush Head (Open ended knurled) S Type	10
Flush Head (Blind ended knurled) SB Type	11
<u>HEXAGONAL :</u>	
Hexagonal Flat Head (Open ended steel) FH Type	12
Hexagonal Flush Head (Open ended steel) SFH Type	13
Hexagonal Flat Head (Open ended stainless steel) FHX Type	14
Hexagonal Flush Head (Open ended stainless steel) SHX Type	15
Hexagonal Small Head (Open ended steel) FHTR Type	16
Stud nuts Flat Head GTP Type	17
Special notes	18
More about SIMAF	19
Tooling	20

SERBLOC

Flat head - open end - type « TP »

Material : Steel zinc yellow.
Stainless steel (AISI 303).
Aluminium.

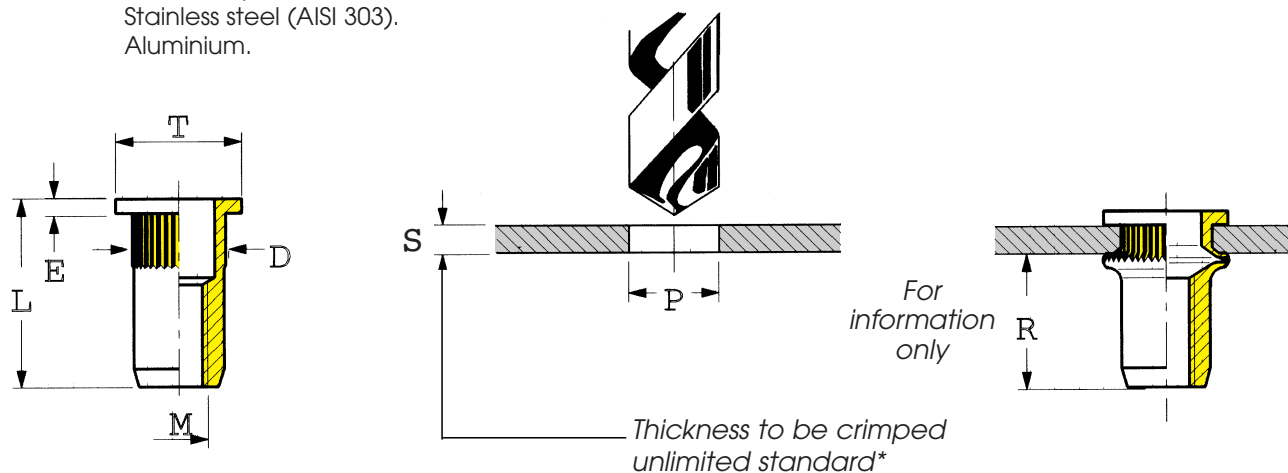

M	DESIGNATION		Thickness to be crimped S	D	E	+0,1 0 P	T	L	R
	STEEL	STAINLESS STEEL							
3	3 TP 15 3 TP 25 3 TP 35	3 TP 15 X 3 TP 25 X 3 TP 35 X	0,5 to 1,5 1,5 to 2,5 2,5 to 3,5	5	0,8	5,1	7	8,6 9,6 10,6	4,3
4	4 TP 15 4 TP 30 4 TP 40	4 TP 15 X 4 TP 30 X 4 TP 40 X	0,5 to 1,5 1,5 to 3 3 to 4	6	0,8	6,1	8	10,5 11,3 12,3	6,2
5	5 TP 15 5 TP 30 5 TP 45	5 TP 15 X 5 TP 30 X 5 TP 45 X	0,5 to 1,5 1,5 to 3 3 to 4,5	7	1,0	7,1	9	11,7 13,2 14,7	6,7
6	6 TP 20 6 TP 35 6 TP 50	6 TP 20 X 6 TP 35 X 6 TP 50 X	1 to 2 2 to 3,5 3,5 to 5	9	1,5	9,1	11	14,5 16 17,5	8
8	8 TP 25 8 TP 40 8 TP 55	8 TP 25 X 8 TP 40 X 8 TP 55 X	1 to 2,5 2,5 to 4 4 to 5,5	11	1,5	11,1	14	16,3 17,8 19,3	8,8
10	10 TP 25 10 TP 40 10 TP 55	10 TP 25 X 10 TP 40 X 10 TP 55 X	1 to 2,5 2,5 to 4 4 to 5,5	13	1,5	13,1	16	19,8 21,3 22,8	11,8
12	12 TP 30 12 TP 45 12 TP 60	12 TP 30 X 12 TP 45 X 12 TP 60 X	1,5 to 3 3 to 4,5 4,5 to 6	16	2,0	16,1	20	24,9 26,4 27,9	15,4

Large crimping nuts

4	4 TP 30 PL		0,5 to 3	6	0,8	6,1	9	11	6,2
5	5 TP 30 PL		0,5 to 3	7	1,0	7,1	10	13	6,7
6	6 TP 30 PL		0,5 to 3	9	1,5	9,1	13	16	10
8	8 TP 30 PL		0,5 to 3	11	1,5	11,1	16	17,5	10,8

* Thicknesses to be crimped indicated in this table are not limited. If you require, we can manufacture any SERBLOC you need (M14, M16, + Brass).

SERBLOC

Flat head - closed end - type « TPB »

Material : Steel zinc yellow.
Stainless steel (AISI 303).

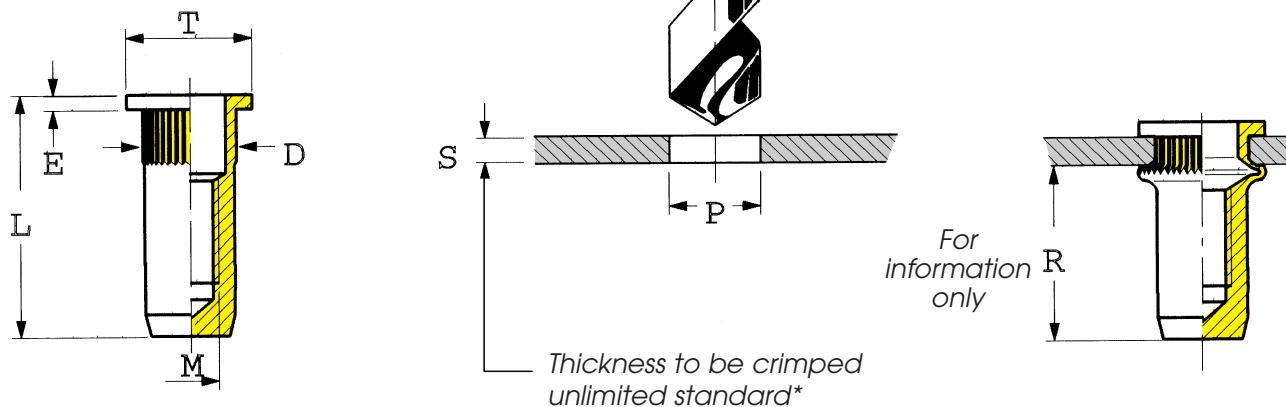

M	DESIGNATION		Thickness to be crimped S	D	E	+0,1 0 P	T	L	R
	STEEL	STAINLESS STEEL							
3	3 TPB 15	3 TPB 15 X	0,5 to 1,5	5	0,8	5,1	7	12	7,7
	3 TPB 25	3 TPB 25 X	1,5 to 2,5					13	
	3 TPB 35	3 TPB 35 X	2,5 to 3,5					14	
4	4 TPB 15	4 TPB 15 X	0,5 to 1,5	6	0,8	6,1	8	14,8	10,5
	4 TPB 30	4 TPB 30 X	1,5 to 3					14,8	
	4 TPB 40	4 TPB 40 X	3 to 4,5					15,8	
5	5 TPB 15	5 TPB 15 X	0,5 to 1,5	7	1,0	7,1	9	17,2	12,2
	5 TPB 30	5 TPB 30 X	1,5 to 3					18,7	
	5 TPB 45	5 TPB 45 X	3 to 4,5					20,2	
6	6 TPB 20	6 TPB 20 X	1 to 2	9	1,5	9,1	11	20,5	14
	6 TPB 35	6 TPB 35 X	2 to 3,5					22	
	6 TPB 50	6 TPB 50 X	3,5 to 5					23,5	
8	8 TPB 25	8 TPB 25 X	1 to 2,5	11	1,5	11,1	14	22,3	14,8
	8 TPB 40	8 TPB 40 X	2,5 to 4					23,8	
	8 TPB 55	8 TPB 55 X	4 to 5,5					25,3	
10	10 TPB 25	10 TPB 25 X	1 to 2,5	13	1,5	13,1	16	26	18
	10 TPB 40	10 TPB 40 X	2,5 to 4					27,5	
	10 TPB 55	10 TPB 55 X	4 to 5,5					29	
12	12 TPB 30	12 TPB 30 X	1,5 to 3	16	2,0	16,1	20	34	24,5
	12 TPB 45	12 TPB 45 X	3 to 4,5					35,5	
	12 TPB 60	12 TPB 60 X	4,5 to 6					37	

* Thicknesses to be crimped indicated in this table are not limited. If you require, we can manufacture any SERBLOC you need (M14, M16, + Brass).

SERBLOC

Large flat head - open end - type « TPL »

Material : Steel zinc yellow.

Stainless steel (AISI 303).

Used especially in soft materials, like polyester when a greater support surface is required.

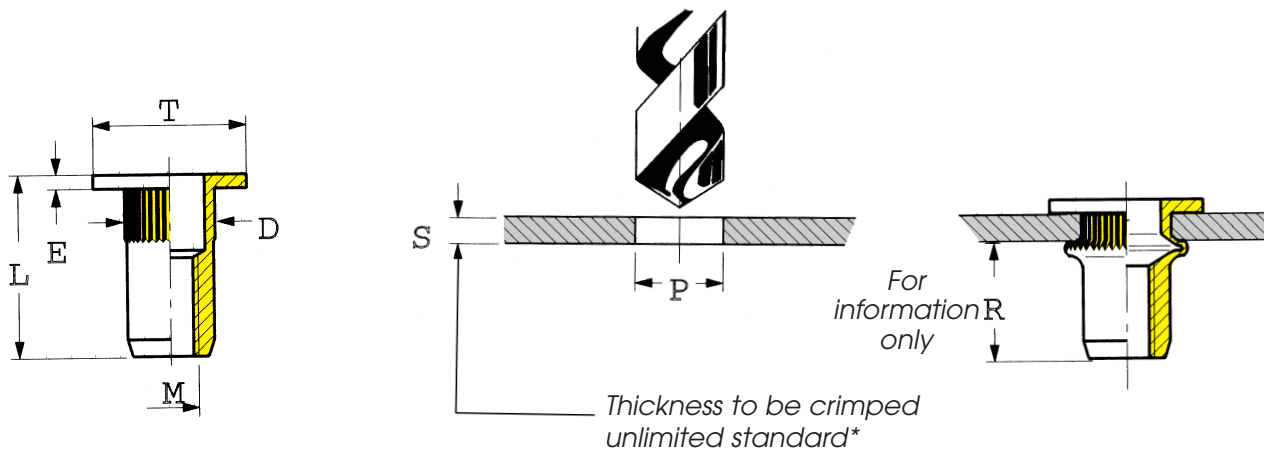

M	DESIGNATION		Thickness to be crimped S	D	E	+0,1 0 P	T	L	R
	STEEL	STAINLESS STEEL							
3	3 TPL 15 3 TPL 25 3 TPL 35	3 TPL 15 X 3 TPL 25 X 3 TPL 35 X	0,5 to 1,5 1,5 to 2,5 2,5 to 3,5	5	0,8	5,1	8	8,6 9,6 10,6	4,3
4	4 TPL 15 4 TPL 30 4 TPL 40	4 TPL 15 X 4 TPL 30 X 4 TPL 40 X	0,5 to 1,5 1,5 to 3 3 to 4	6	0,8	6,1	10	10,5 11,3 12,3	6,2
5	5 TPL 15 5 TPL 30 5 TPL 45	5 TPL 15 X 5 TPL 30 X 5 TPL 45 X	0,5 to 1,5 1,5 to 3 3 to 4,5	7	1,0	7,1	11	11,7 13,2 14,7	6,7
6	6 TPL 20 6 TPL 35 6 TPL 50	6 TPL 20 X 6 TPL 35 X 6 TPL 50 X	1 to 2 2 to 3,5 3,5 to 5	9	1,5	9,1	13	14,5 16 17,5	8
8	8 TPL 25 8 TPL 40 8 TPL 55	8 TPL 25 X 8 TPL 40 X 8 TPL 55 X	1 to 2,5 2,5 to 4 4 to 5,5	11	1,5	11,1	16	16,3 17,8 19,3	8,8
10	10 TPL 25 10 TPL 40 10 TPL 55	10 TPL 25 X 10 TPL 40 X 10 TPL 55 X	1 to 2,5 2,5 to 4 4 to 5,5	13	1,5	13,1	19	19,8 21,3 22,8	11,8
12	12 TPL 30 12 TPL 45 12 TPL 60	12 TPL 30 X 12 TPL 45 X 12 TPL 60 X	1,5 to 3 3 to 4,5 4,5 to 6	16	2,0	16,1	23	24,9 26,4 27,9	15,4

* Thicknesses to be crimped indicated in this table are not limited. If you require, we can manufacture any SERBLOC you need (M14, M16, + Brass).

SERBLOC

Large flat head - closed end - type « TPLB »

Material : Steel zinc yellow.

Stainless steel (AISI 303).

Used especially in soft materials, like polyester when a greater support surface is required.

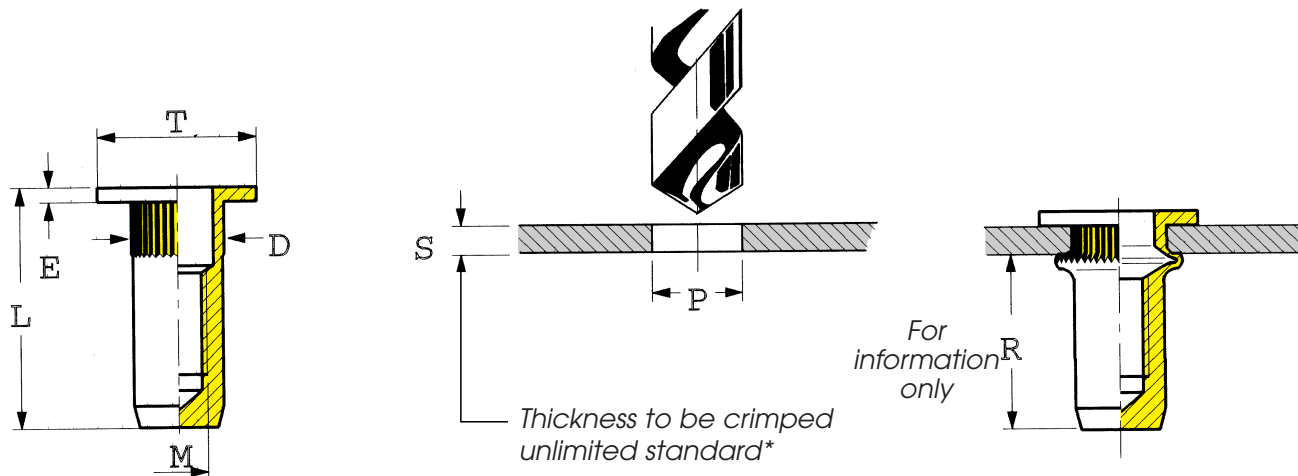

M	DESIGNATION		Thickness to be crimped S	D	E	+0,1 0 P	T	L	R
	STEEL	STAINLESS STEEL							
3	3 TPLB 15	3 TPLB 15 X	0,5 to 1,5	5	0,8	5,1	8	12	7,7
	3 TPLB 25	3 TPLB 25 X	1,5 to 2,5					13	
	3 TPLB 35	3 TPLB 35 X	2,5 to 3,5					14	
4	4 TPLB 15	4 TPLB 15 X	0,5 to 1,5	6	0,8	6,1	10	14,8	10,5
	4 TPLB 30	4 TPLB 30 X	1,5 to 3					14,8	
	4 TPLB 40	4 TPLB 40 X	3 to 4,5					15,8	
5	5 TPLB 15	5 TPLB 15 X	0,5 to 1,5	7	1,0	7,1	11	17,2	12,2
	5 TPLB 30	5 TPLB 30 X	1,5 to 3					18,7	
	5 TPLB 45	5 TPLB 45 X	3 to 4,5					20,2	
6	6 TPLB 20	6 TPLB 20 X	1 to 2	9	1,5	9,1	13	20,5	14
	6 TPLB 35	6 TPLB 35 X	2 to 3,5					22	
	6 TPLB 50	6 TPLB 50 X	3,5 to 5					23,5	
8	8 TPLB 25	8 TPLB 25 X	1 to 2,5	11	1,5	11,1	16	22,3	14,8
	8 TPLB 40	8 TPLB 40 X	2,5 to 4					23,8	
	8 TPLB 55	8 TPLB 55 X	4 to 5,5					25,3	
10	10 TPLB 25	10 TPLB 25 X	1 to 2,5	13	1,5	13,1	19	26	18
	10 TPLB 40	10 TPLB 40 X	2,5 to 4					27,5	
	10 TPLB 55	10 TPLB 55 X	4 to 5,5					29	
12	12 TPLB 30	12 TPLB 30 X	1,5 to 3	16	2,0	16,1	23	34	24,5
	12 TPLB 45	12 TPLB 45 X	3 to 4,5					35,5	
	12 TPLB 60	12 TPLB 60 X	4,5 to 6					37	

* Thicknesses to be crimped indicated in this table are not limited. If you require, we can manufacture any SERBLOC you need (M14. M16. + Brass).

Countersunk head - open end - type « TF »

Material : Steel zinc yellow.
Stainless steel (AISI 303).
Aluminium.

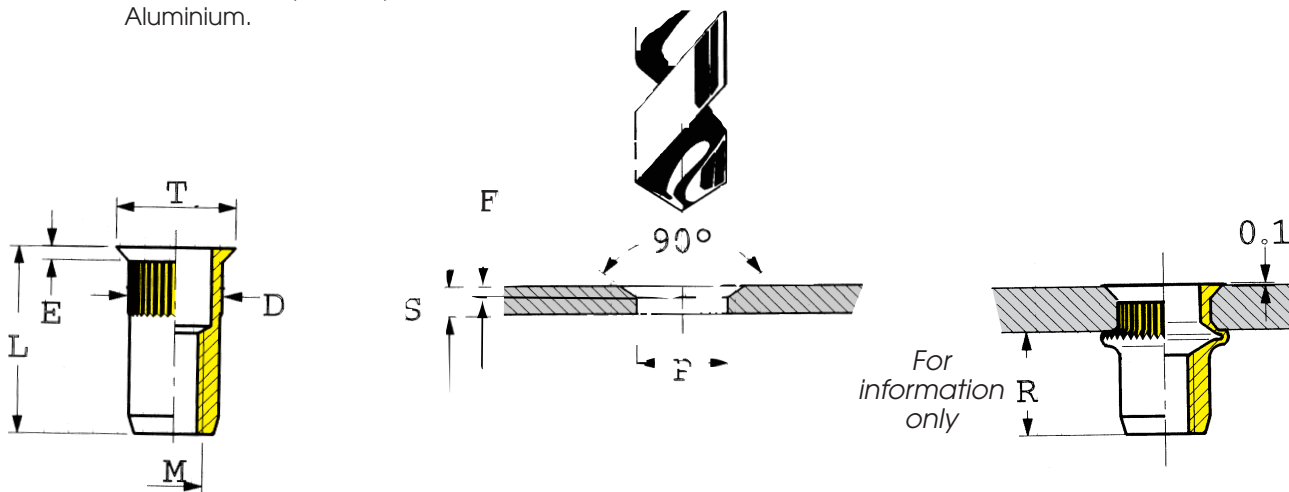

Thickness to be crimped
unlimited standard*

M	DESIGNATION		Thickness to be crimped S	D	E	+0,1 0 P	T	F	L	R
	STEEL	STAINLESS STEEL								
3	3 TF 20	3 TF 20 X	1 to 2	5	1	5,1	6,8	0,9	8,3	4,8
	3 TF 30	3 TF 30 X	2 to 3							
4	4 TF 20	4 TF 20 X	1 to 2	6	1	6,1	7,8	0,9	9,5	5,5
	4 TF 30	4 TF 30 X	2 to 3							
	4 TF 40	4 TF 40 X	3 to 4							
5	5 TF 20	5 TF 20 X	1 to 2	7	1	7,1	8,8	0,9	10,5	6
	5 TF 30	5 TF 30 X	2 to 3							
	5 TF 40	5 TF 40 X	3 to 4							
6	6 TF 20	6 TF 20 X	1 to 2	9	1	9,1	10,8	0,9	13	8,6
	6 TF 35	6 TF 35 X	2 to 3,5							
	6 TF 50	6 TF 50 X	3,5 to 5							
8	8 TF 30	8 TF 30 X	1,5 to 3	11	1,5	11,1	13,8	1,4	15,3	9,8
	8 TF 45	8 TF 45 X	3 to 4,5							
	8 TF 60	8 TF 60 X	4,5 to 6							
10	10 TF 35	10 TF 35 X	2 to 3,5	13	1,5	13,1	15,8	1,4	19,3	13
	10 TF 50	10 TF 50 X	3,5 to 5							
	10 TF 65	10 TF 65 X	5 to 6,5							
12	12 TF 40	12 TF 40 X	2 to 4	16	2	16,1	19,8	1,9	23,9	14,3
	12 TF 55	12 TF 55 X	4 to 5,5							
	12 TF 70	12 TF 70 X	5,5 to 7							

* Thicknesses to be crimped indicated in this table are not limited. If you require, we can manufacture any SERBLOC you need (M14, M16, + Brass).

Countersunk head - closed end - type « TFB »

Material : Steel zinc yellow.
Stainless steel (AISI 303).

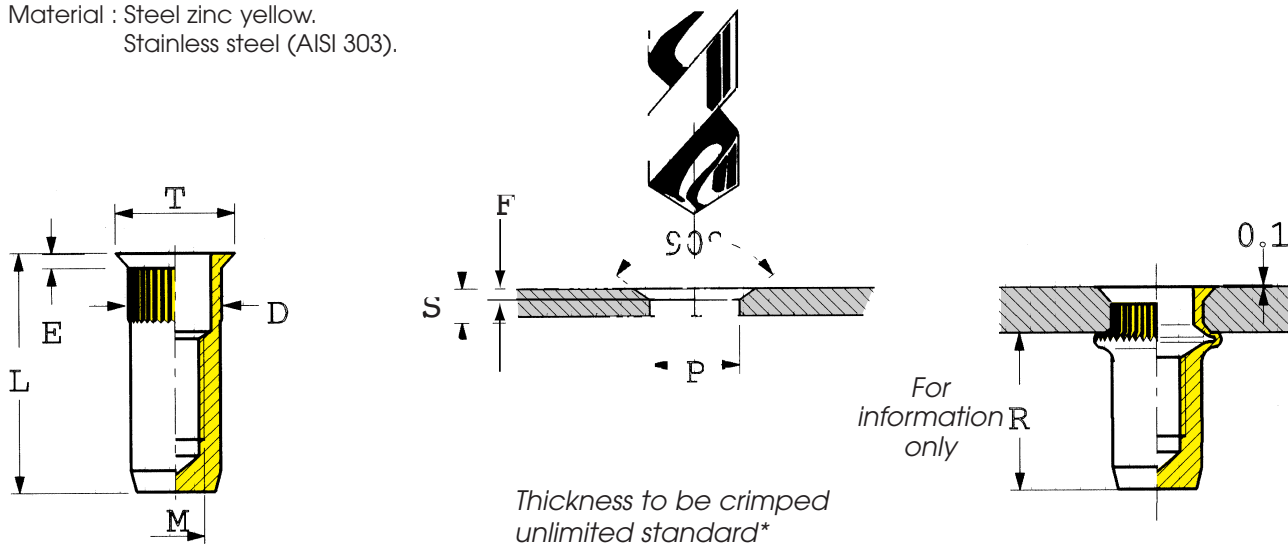

M	DESIGNATION		Thickness to be crimped S	D	E	+0,1 0 P	T	F	L	R
	STEEL	STAINLESS STEEL								
3	3 TFB 20	3 TFB 20 X	1 to 2	5	1	5,1	6,8	0,9	11,7 12,7	8,2
	3 TFB 30	3 TFB 30 X	2 to 3							
4	4 TFB 20	4 TFB 20 X	1 to 2	6	1	6,1	7,8	0,9	13 14 15	9
	4 TFB 30	4 TFB 30 X	2 to 3							
	4 TPB 40	4 TPB 40 X	3 to 4							
5	5 TFB 20	5 TFB 20 X	1 to 2	7	1	7,1	8,8	0,9	16,7 17,7 18,7	11,5
	5 TFB 30	5 TFB 30 X	2 to 3							
	5 TFB 40	5 TFB 40 X	3 to 4							
6	6 TFB 20	6 TFB 20 X	1 to 2	9	1	9,1	10,8	0,9	21 23 24,5	16,6
	6 TFB 35	6 TFB 35 X	2 to 3,5							
	6 TFB 50	6 TFB 50 X	3,5 to 5							
8	8 TFB 30	8 TFB 30 X	1,5 to 3	11	1,5	11,1	13,8	1,4	21,3 22,8 24,3	15,8
	8 TFB 45	8 TFB 45 X	3 to 4,5							
	8 TFB 60	8 TFB 60 X	4,5 to 6							
10	10 TFB 35	10 TFB 35 X	2 to 3,5	13	1,5	13,1	15,8	1,4	25,3 26,8 28,3	19
	10 TFB 50	10 TFB 50 X	3,5 to 5							
	10 TFB 65	10 TFB 65 X	5 to 6,5							
12	12 TFB 40	12 TFB 40 X	2 to 4	16	2	16,1	19,8	1,9	32,9 34,4 35,9	23,3
	12 TFB 55	12 TFB 55 X	4 to 5,5							
	12 TFB 70	12 TFB 70 X	5,5 to 7							

* Thicknesses to be crimped indicated in this table are not limited. If you require, we can manufacture any SERBLOC you need (M14, M16, + Brass).

SERFIN

Flush head - open end - type "S"

Material : Steel zinc yellow.
Stainless steel (AISI 303).

AVDANTAGES

The SERFIN nut, a SERBLOC derivative, has the same anchoring benefits as the latter. It is used for even thinner materials and avoids the need for further support countersinking, its capacity is slightly less than the countersunk head SERBLOC. The same tools, manual or hydro-pneumatic, as SERBLOC are used to mount the nut whose head fits into the support and lies flush with it. The SERFIN flutes grip into the material giving greater resistance to screwing torque.

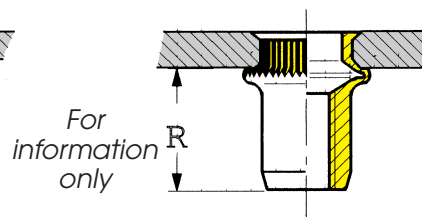
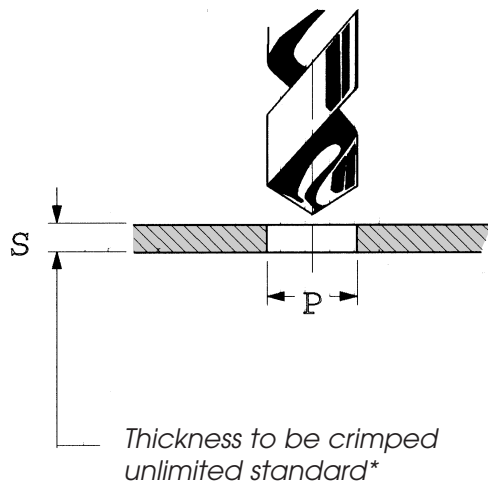
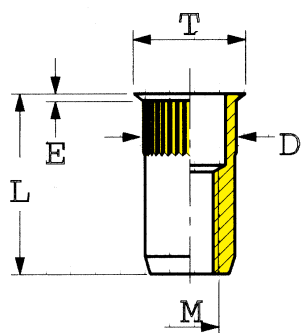

M	DESIGNATION		Thickness to be crimped S	D	E	+0,1 0 P	T	L	R
	STEEL	STAINLESS STEEL							
3	S 3	S 3 X	0,5 to 2	4,7	0,4	4,8	5,5	8,5	4,5
	S 3 A	S 3 A X	0,5 to 2	5	0,4	5,1	5,8	8,3	4,3
4	S 4	S 4 X	0,5 to 2	6,3	0,4	6,4	7,1	10,2	6
	S 4 A	S 4 A X	0,5 to 2	6	0,4	6,1	6,8	9,5	5,5
5	S 5	S 5 X	0,5 to 2	7,1	0,5	7,2	8	12	7,8
	S 5 A	S 5 A X	0,5 to 2	7	0,5	7,1	8	11,2	7,2
6	S 6	S 6 X	1 to 3	9,4	0,6	9,5	10,4	14	9
	S 6 A	S 6 A X	1 to 2	9	0,5	9,1	10	13	8,5
8	S 8	S 8 X	1 to 3	12,6	0,6	12,7	13,6	14,5	9,3
	S 8 A	S 8 A X	1 to 3	10,5	0,6	10,6	11,3	15,5	10
	S 8 B	S 8 B X	1 to 3	11	0,5	11,1	12	14,2	10,3
10	S 10	S 10 X	1 to 3	14,1	0,7	14,2	15,2	18	13,3
	S 10 A	S 10 A X	1 to 3,5	13	0,7	13,1	14,4	19,3	15
12	S 12	S 12 X	1,4 to 4	16,1	0,7	16,2	17,2	19	14,5
	S 12 A	S 12 A X	1,4 to 4	16	0,7	16,1	17,4	23,9	19,5

* Thicknesses to be crimped indicated in this table are not limited. If you require, we can manufacture any SERBLOC you need.

SERFIN

Flush head - closed end - type « SB »

Material : Steel zinc yellow.
Stainless steel (AISI 303).

ADVANTAGES

The SERFIN nut, a SERBLOC derivative, has the same anchoring benefits as the latter. It is used for even thinner materials and avoids the need for further support countersinking, its capacity is slightly less than the countersunk head SERBLOC. The same tools, manual or hydro-pneumatic, as SERBLOC are used to mount the nut whose head fits into the support and lies flush with it. The SERFIN flutes grip into the material giving greater resistance to screwing torque.

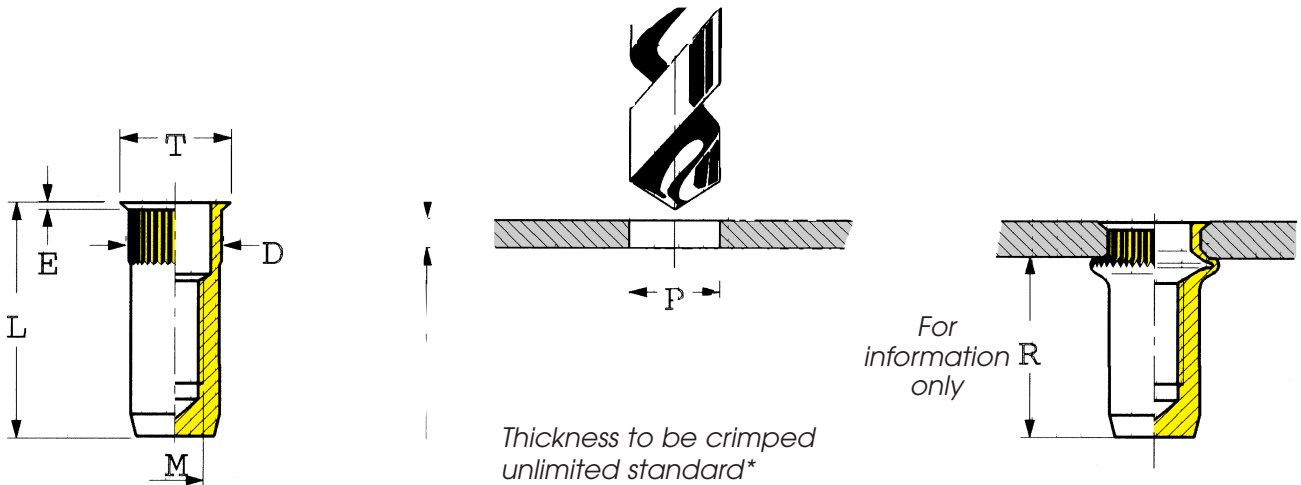

M	DESIGNATION		Thickness to be crimped S	D	E	+0,1 0 P	T	L	R
	STEEL	STAINLESS STEEL							
3	SB 3	SB 3 X	0,5 to 2	4,7	0,4	4,8	5,5	12,3	8,3
	SB 3 A	SB 3 A X	0,5 to 2	5	0,4	5,1	5,8	11,7	7,7
4	SB 4	SB 4 X	0,5 to 2	6,3	0,4	6,4	7,1	14	9,8
	SB 4 A	SB 4 A X	0,5 to 2	6	0,4	6,1	6,8	13	9
5	SB 5	SB 5 X	0,5 to 2	7,1	0,5	7,2	8	17,5	13,3
	SB 5 A	SB 5 A X	0,5 to 2	7	0,5	7,1	8	16,7	12,7
6	SB 6	SB 6 X	1 to 3	9,4	0,6	9,5	10,4	20	15
	SB 6 A	SB 6 A X	1 to 2	9	0,5	9,1	10	19	14,5
8	SB 8	SB 8 X	1 to 3	12,6	0,6	12,7	13,6	20,5	15,3
	SB 8 A	SB 8 A X	1 to 3	10,5	0,6	10,6	11,3	21,5	16
	SB 8 B	SB 8 B X	1 to 3	11	0,5	11,1	12	21,3	16,3
10	SB 10	SB 10 X	1 to 3	14,1	0,7	14,2	15,2	24,5	19,8
	SB 10 A	SB 10 A X	1 to 3,5	13	0,7	13,1	14,4	25,3	21
12	SB 12	SB 12 X	1,4 to 4	16,1	0,7	16,2	17,2	25,5	21
	SB 12 A	SB 12 A X	1,4 to 4	16	0,7	16,1	17,4	32,9	28,5

* Thicknesses to be crimped indicated in this table are not limited. If you require, we can manufacture any SERBLOC you need.

HEXAGONAUX

Hexagonal flat head - open end - type « FH »

Material : Steel zinc yellow.

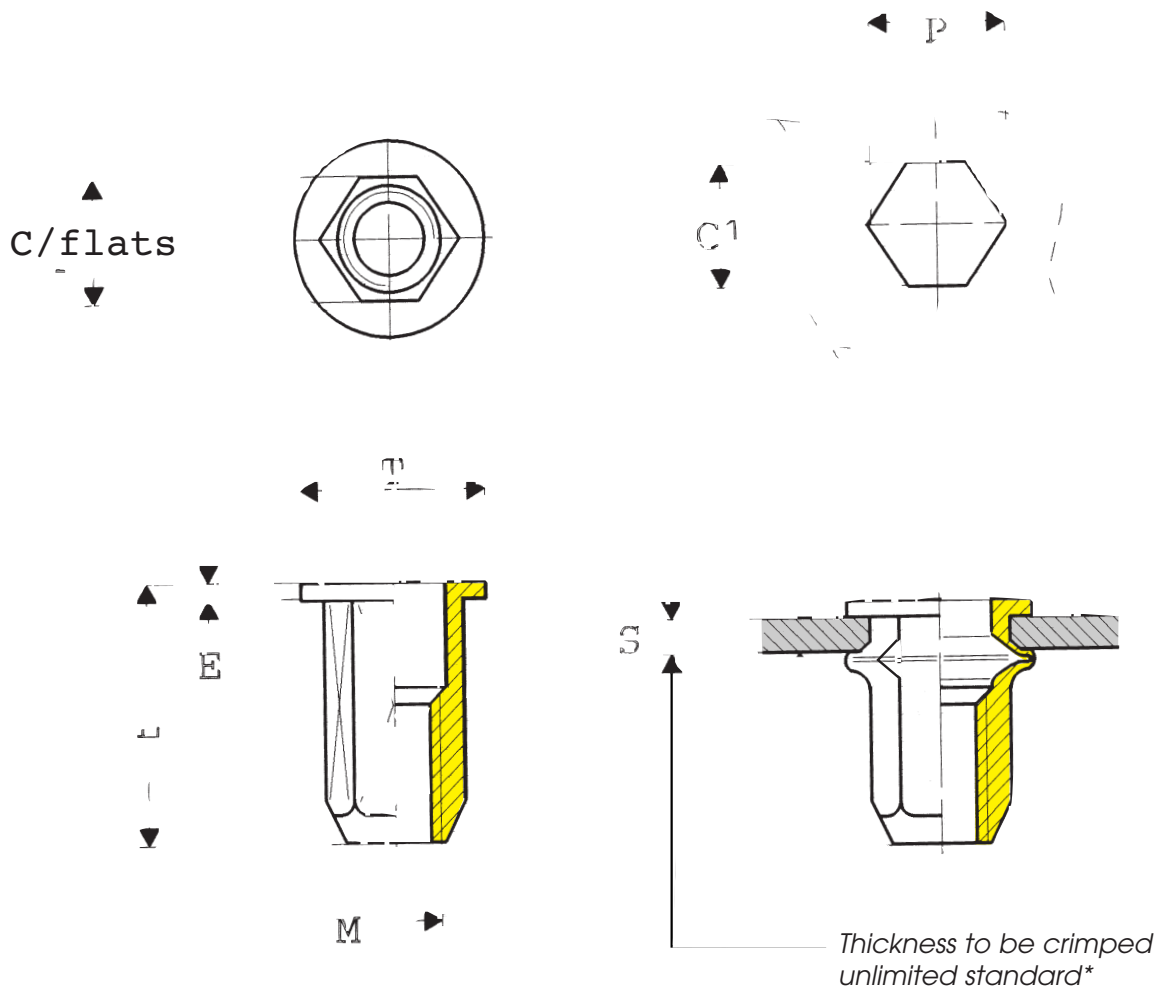

M	Designation	C/flats	E	Punching + 0,1 C1 0	Drill P	Thickness to be crimped S	T	L
4	FH4 FHL4	5,97	0,8	6	6,8	0,5 to 2 1,5 to 4	9	10,5 12,5
5	FH5 FHL5	6,97	1	7	7,85	0,5 to 2,5 2 to 4,5	10	12,5 14,5
6	FH6 FHL6	8,97	1,2	9	9,95	0,5 to 3 2,5 to 5,5	12	16 18,5
8	FH8 FHL8	10,97	1,3	11	12,15	0,5 to 3,5 3 to 6	14	17 19,5
10	FH10 FHL10	12,97	1,5	13	14,25	0,5 to 3,5 3 to 6	16	21 23,5

* Thicknesses to be crimped indicated in this table are not limited. If you require, we can manufacture any SERBLOC you need.

HEXAGONAUX

Hexagonal flush head - open end - type « SFH »

Material : Steel zinc yellow.

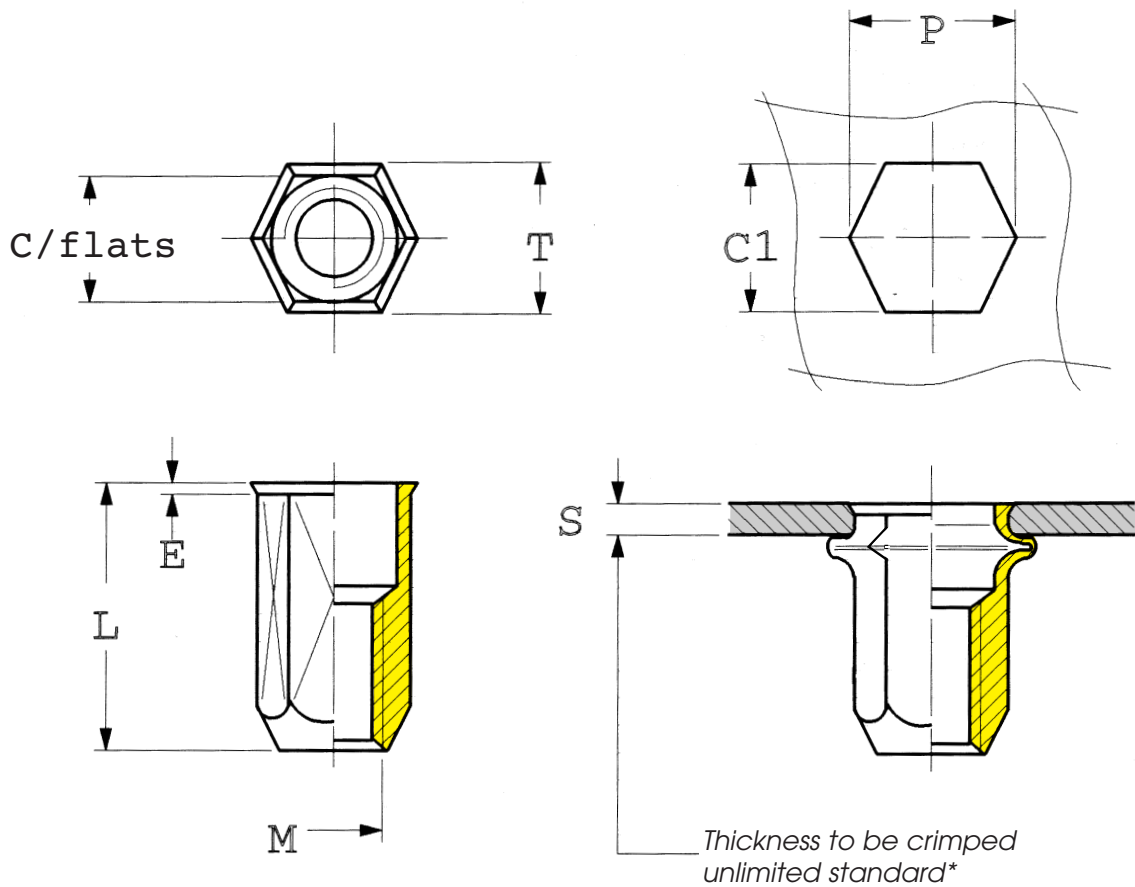

M	Designation	C/flats	E	Punching + 0,1 C1 0	Drill P	Thickness to be crimped S	T	L
4	SFH4 SFHL4	5,97	0,5	6	6,8	0,5 to 2 1,5 to 4	6,7	10 12
5	SFH5 SFHL5	6,97	0,6	7	7,85	0,5 to 2 2 to 4,5	8	12 14
6	SFH6 SFHL6	8,97	0,6	9	9,95	0,5 to 3 2,5 to 5,5	10	15 17,5
8	SFH8 SFHL8	10,97	0,6	11	12,15	0,5 to 3,5 3 to 6	12	16 18,5
10	SFH10 SFHL10	12,97	0,9	13	14,25	0,5 to 3,5 3 to 6	14,5	20 22,5

* Thicknesses to be crimped indicated in this table are not limited. If you require, we can manufacture any SERBLOC you need.

HEXAGONAUX

Hexagonal flat head - open end - type « FHX ».

Material : Stainless steel (AISI 303).

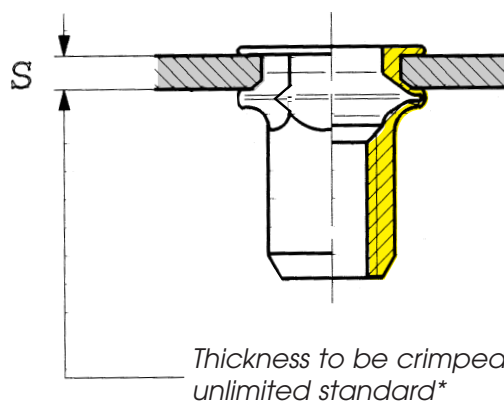
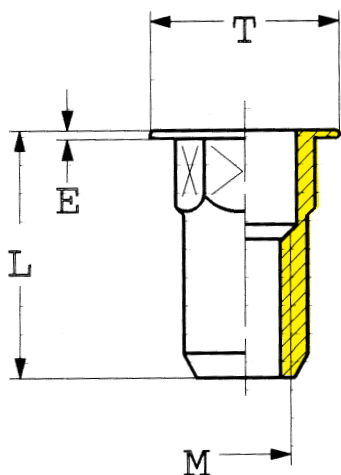
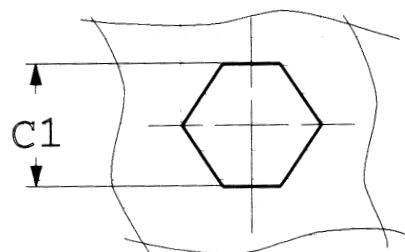
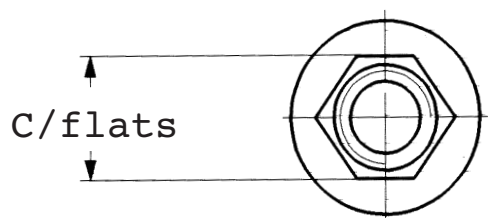

M	Designation	C/flats	E	Punching + 0,1 C1 0	Thickness to be crimped S	T	L
4	FH4X	5,95	0,8	6,0	0,5 to 2	8	10,3
5	FH5X	6,95	1	7,0	0,5 to 2	9	13
6	FH6X	8,95	1,5	9,0	1 to 2	11	15,3
8	FH8X	10,95	1,5	11,0	1 to 3	14	15,7
10	FH10X	12,95	1,5	13,0	1 to 3	16	20

* Thicknesses to be crimped indicated in this table are not limited. If you require, we can manufacture any SERBLOC you need.

HEXAGONAUX

Hexagonal flush head - open end - type « SHX »

Material : Stainless steel (AISI 303).

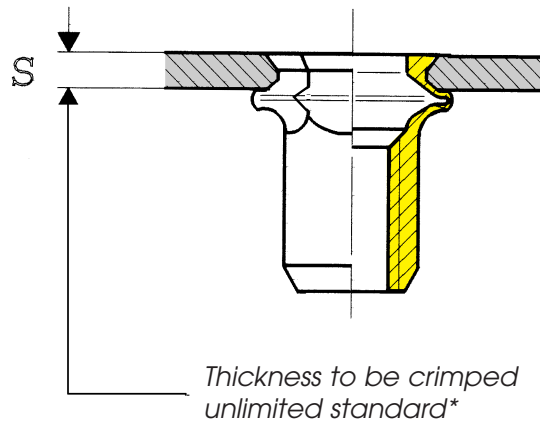
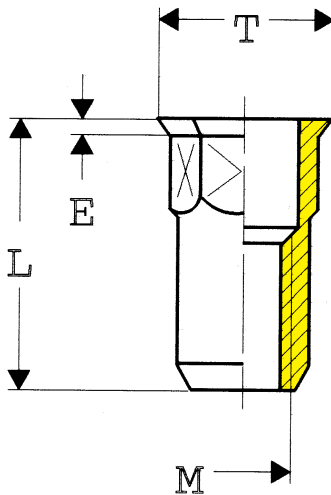
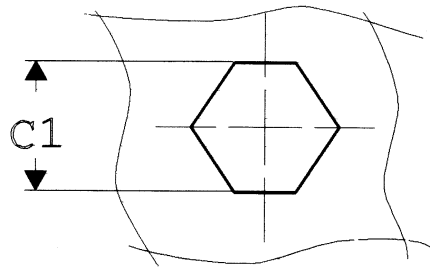
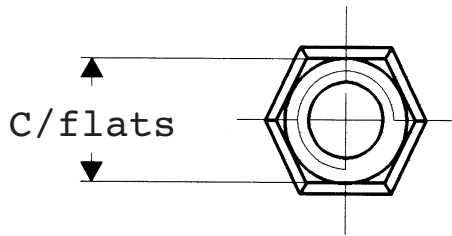

M	Designation	C/flats	E	Punching + 0,1 C1 0	Thickness to be crimped S	T	L
4	SH4X	5,95	0,5	6,0	0,5 to 2	6,8	9,5
5	SH5X	6,95	0,5	7,0	0,5 to 2	8	12
6	SH6X	8,95	0,5	9,0	1 to 2	10	13,8
8	SH8X	10,95	0,5	11,0	1 to 3	11,8	14,2

* Thicknesses to be crimped indicated in this table are not limited. If you require, we can manufacture any SERBLOC you need.

HEXAGONAUX

Hexagonal small head - open end - type « FHTR »

Material : Steel zinc yellow.

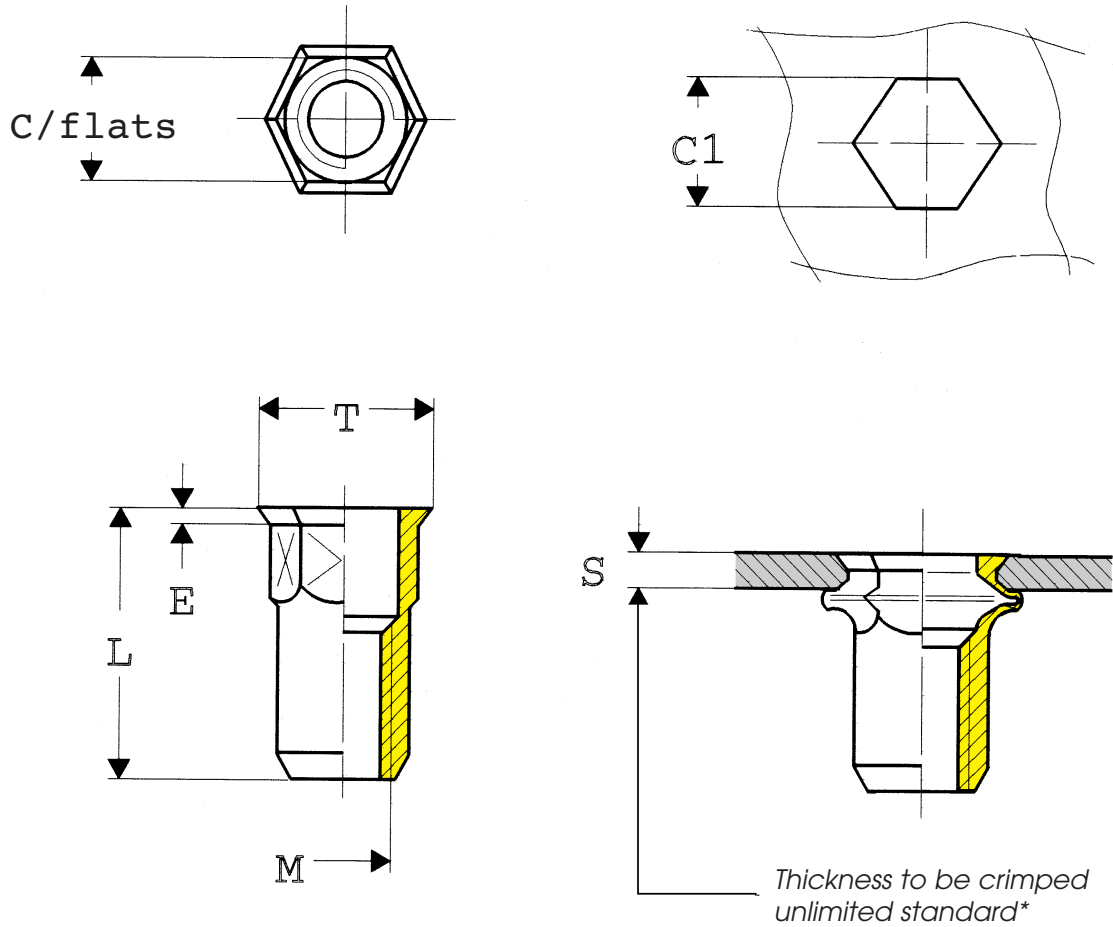

M	Designation	C/flats	E	Punching + 0,1 C1 0	Thickness to be crimped S	T	L
4	FHTR4	6,35	0,6	6,4	0,5 to 2	8	10,5
5	FHTR5	7,25	0,6	7,3	0,5 to 3	9	11,5
6	FHTR6	9,65	0,8	9,7	0,5 to 3	12	14,5
8	FHTR8	10,65	0,8	10,7	0,5 to 3	13	16

* Thicknesses to be crimped indicated in this table are not limited. If you require, we can manufacture any SERBLOC you need.

GOUJON SERBLOC

Stud nuts flat head type « GTP »

Material : Steel zinc yellow.

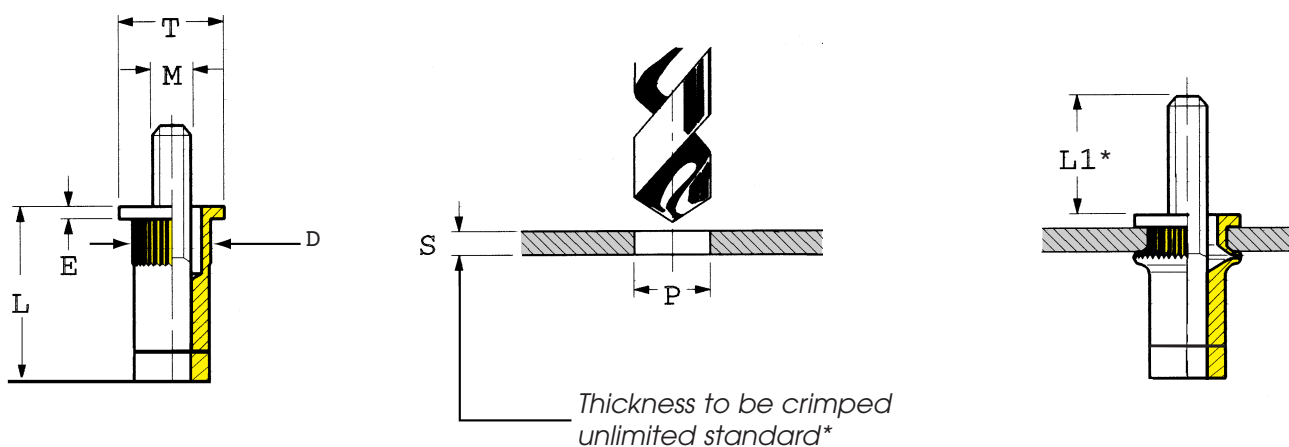

M	REFERENCES	Thickness to be crimped S*	D	E	P	L	L1*	T
4	G4 TP 15 (L1) G4 TP 30 (L1) G4 TP 40 (L1)	0,5 to 1,5 1,5 to 3 3 to 4	6	0,8	6,1	15,00 16,50 18,00	10 12 15	8
5	G5 TP 15 (L1) G5 TP 30 (L1) G5 TP 45 (L1)	0,5 to 1,5 1,5 to 3 3 to 4,5	7	1	7,1	17,00 18,50 20,00	10 12 15	9
6	G6 TP 20 (L1) G6 TP 35 (L1) G6 TP 50 (L1)	1 to 2 2 to 3,5 3,5 to 5	9	1,5	9,1	20,00 21,50 23,00	10 15 20	11
8	G8 TP 25 (L1) G8 TP 40 (L1) G8 TP 55 (L1)	1 to 2,5 2,5 to 4 4 to 5,5	11	1,5	11,1	21,00 22,50 24,00	10 15 20	14

* Thicknesses to be crimped indicated in this table are not limited. If you require, we can manufacture any SERBLOC you need.

Special nota and technical data

Interloc **61 avenue de l'Europe - 78140 Vélizy-Villacoublay - Tel :00 33 (0)1 78 74 32 00 - Fax : 00 33 (0)1 78 74 32 01**

61 avenue de l'Europe - 78140 Vélizy-Villacoublay - Tel :00 33 (0)1 78 74 32 00 - Fax : 00 33 (0)1 78 74 32 01

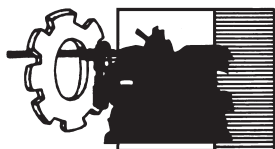
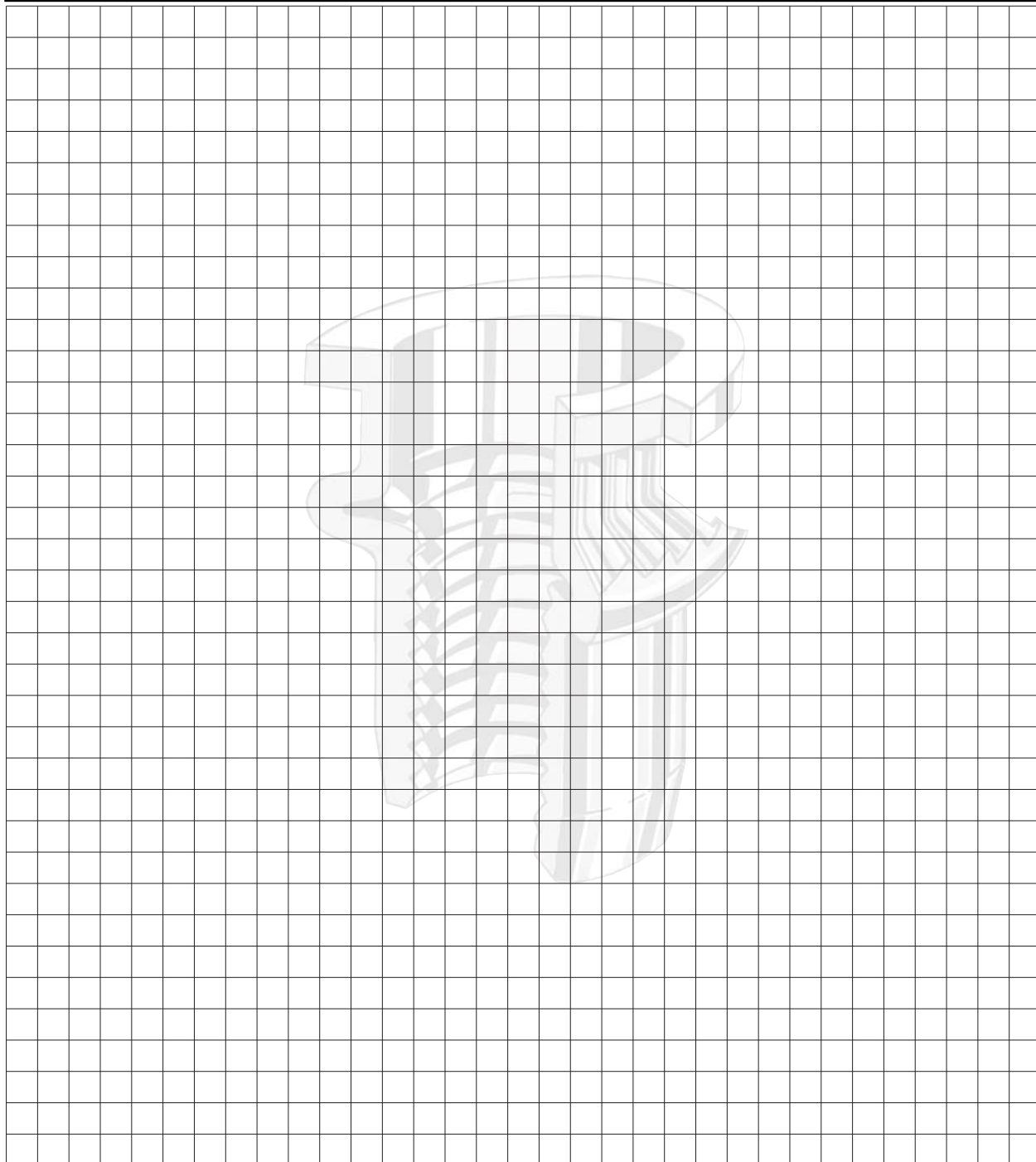

SIMAF

*61 avenue de l'Europe
78140 Vélizy-Villacoublay
Tel :00 33 (0)1 78 74 32 00
Fax : 00 33 (0)1 78 74 32 01*

SIMAF IS ALSO :

GOUJON

SELF-CLINCHING
STUDS



COLONNETTE

SELF-CLINCHING
STANDOFFS



SERECROU

INTERNALLY THREADED
SELF-CLINCHING NUTS



SERBLIND

BLIND RIVETS
*Available in large variety
of types and materials*



SERCAGE

CAGE NUT
for thin metal sheet

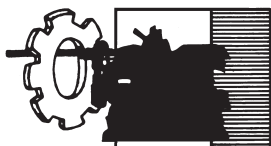

SIMAF

61 avenue de l'Europe
78140 Vélizy-Villacoublay
Tel : 00 33 (0)1 78 74 32 00
Fax : 00 33 (0)1 78 74 32 01

manual mounting tools for small series

semi-automatic mounting tools for large series



A HAND CLAMP with manual screwing and unscrewing of SERBLOC.
To mount SERBLOC - M3, M4, M5 steel nuts and M6 aluminium nuts.
Sold with M3, M4, M5 and M6 tools.



PNEUMO-OIL compact device with automatic screwing of bolts by pressing the connecting mandrel.
To mount SERBLOC nuts in the M3 to M8 range, in difficult accessible places.
Sold with M3 to M8 tools.

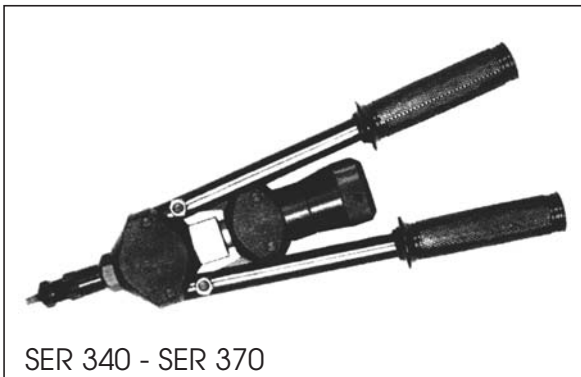

A HAND CLAMP with a rapid screwing and unscrewing device.
SER 340 : To mount SERBLOC M4 to M6.
SER 370 : To mount SERBLOC M6 to M10.
Sold with their tools.



PNEUMO-OIL device with a single trigger for screwing, tightening and unscrewing.
To mount SERBLOC nuts from M3 to M10 range, in large series.
Sold with M3 to M10 tools.

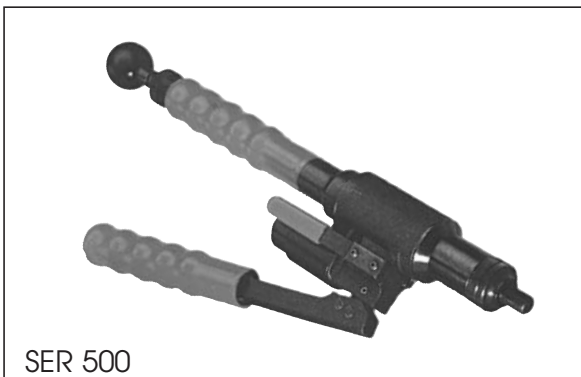

A HAND CLAMP with two levers and a rapid screwing and unscrewing device.
To mount SERBLOC nuts in the M6 to M14 range.
Sold with are tooling.



PNEUMO-OIL device with a single trigger for screwing, tightening and unscrewing.
To mount SERBLOC nuts in the M8 to M16 range, in large series.
Sold with M10 to M12 tools.

SIMAF

Quality is our main vocation

By adapting our production to new technologies, we have managed to gain the confidence of both small enterprises and major international corporations, in leading economic sectors like the automobile industry, household appliances, telephone, office automation, computer technology, etc.



SIMAF PRODUCTION has a golden rule of permanent control, from manufacture to distribution which has guaranteed a constant quality of our production.

Our production tools are perfectly well adapted to the manufacture of simple or complex machine parts in different types of material such as : steel, stainless steel, brass, plastics, and this for small, medium and high volume.



SIMAF

*61 avenue de l'Europe
78140 Vélizy-Villacoublay
Tel : 00 33 (0)1 78 74 32 00
Fax : 00 33 (0)1 78 74 32 01*